



Dadswood | Harlow | CM20 1JL

£1,350 Per Month

 clarknewman



Dadswood | Harlow | CM20 1JL

£1,350 Per Month

A TWO BEDROOM TOP FLOOR FLAT with Juliet balcony adjacent to Harlow Town Centre. The property boasts a spacious lounge/diner, fitted kitchen and large entrance hall with ample storage. Further benefits include a generously sized double bedroom, a single bedroom and family bathroom suite. The carpark is permit parking with two permits allocated to each flat. The property is available unfurnished NOW. This is a non-smoking property and the landlord does not allow pets. Online virtual tour available.

- Two Bedrooms
- Unfurnished
- Council Tax Band: C
- Top Floor Flat
- Available NOW
- EPC Rating: D

#### Front

Permit parking (two permits). Communal front door with secure intercom system.

#### Hallway

3'9" x 10'4" (1.14m x 3.15m)

Electrical consumer unit over door. Secure entry intercom to wall. Timber fire door to communal landing. Internal doors to living room, bedrooms, bathroom and airing cupboard.





### Living Room

13'11" x 11'10" (4.24m x 3.61m)

Juliet balcony with double UPVC doors. Electric storage radiator to wall. Internal doors to entrance hall and kitchen.

### Kitchen

9'0" x 7'10" (2.74m x 2.39m)

UPVC double glazed window. Fitted kitchen with laminate worktops and appliances including fridge freezer, washing machine and electric cooker. Extractor fan. Internal door to living room.

### Bedroom One

9'4" x 9'0" (2.84m x 2.74m)

UPVC double glazed window, electric radiator to wall. Built in wardrobes. Internal door to entrance hall.

### Bedroom Two

10'5" x 6'11" (3.18m x 2.11m)

UPVC double glazed window, radiator to wall. Internal door to entrance hall.

### Bathroom

7'9" x 5'6" (2.36m x 1.68m)

White bathroom suite with part-panelled walls around bath and pedestal sink. Electric shower over bath with glass screen. Electric fan heater and extractor fan to wall.

### Local Area

Dadswood is a private development adjacent to Harlow Town Centre. There is a large communal carpark for residents with 2 permits per household. Dadswood is also only a short distance to Princess Alexandra Hospital (0.5 miles) and Harlow Town Train Station (1.2 miles) with trains direct to Tottenham Hale, Liverpool Street and Cambridge.



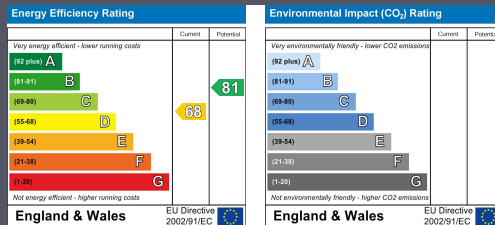
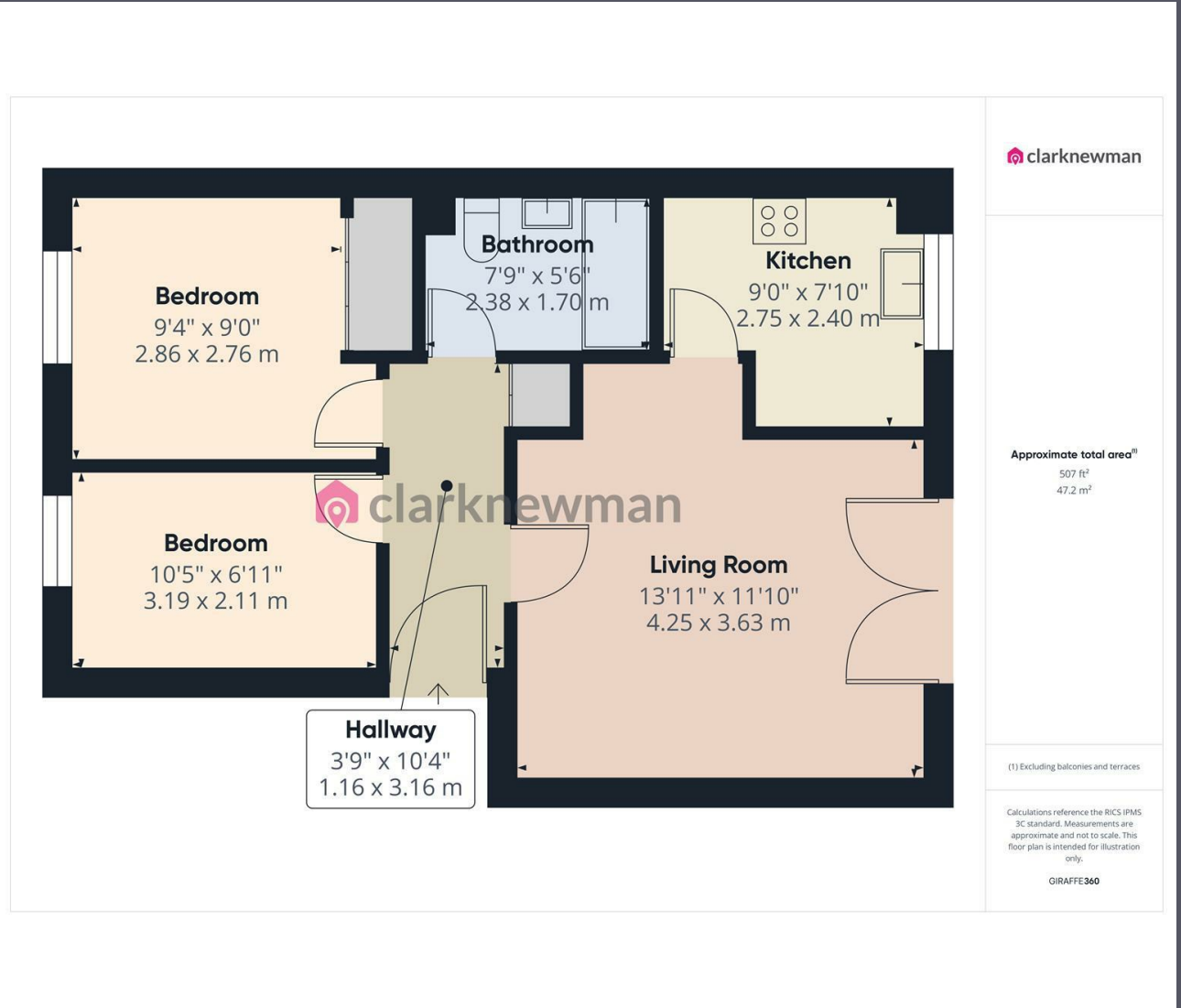
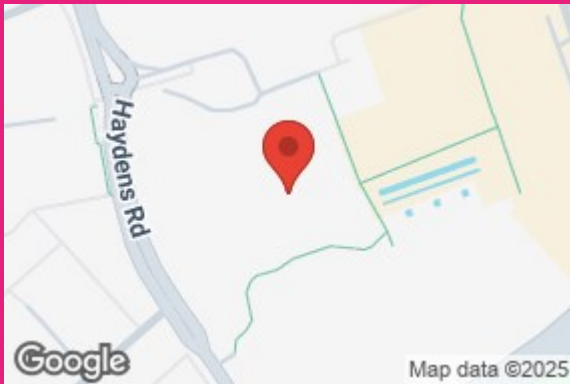

Equity House  
4-6 Market Street  
Harlow  
Essex  
CM17 0AH  
01279 400444  
hello@clarknewman.co.uk